

Scanco

innovation  
service  
experience

# Wisconsin Sage 100 User Group 2018

sage 100

sage 100c

## Sage Mobility for Warehouse Automation



Kristen Baumgartner – Scanco Software Specialist

# About Us

## WAREHOUSE MANAGEMENT & MANUFACTURING AUTOMATION SOLUTIONS

Since 1989, Scanco has been a leading provider of supply chain automation software and services. Since our inception, we have focused on innovative warehouse management solutions with a unique technology-driven approach. Our solutions deliver unequaled efficiency and visibility for distribution and manufacturing companies around the globe.

From basic barcoding to the most complex distribution and manufacturing operations- Scanco software is positioned to grow with our customers ever changing business needs. We are focused on providing top-tier, fully integrated automation solutions built specifically for your ERP solution. Today, thousands of world-class distribution and manufacturing companies have automated their facilities with cutting-edge Scanco technology.



# Agenda

- Why Automate?
- What is Mobility for Barcode?
- A Day in the Life of Inventory
- Questions & Answers
- How to Get More Information

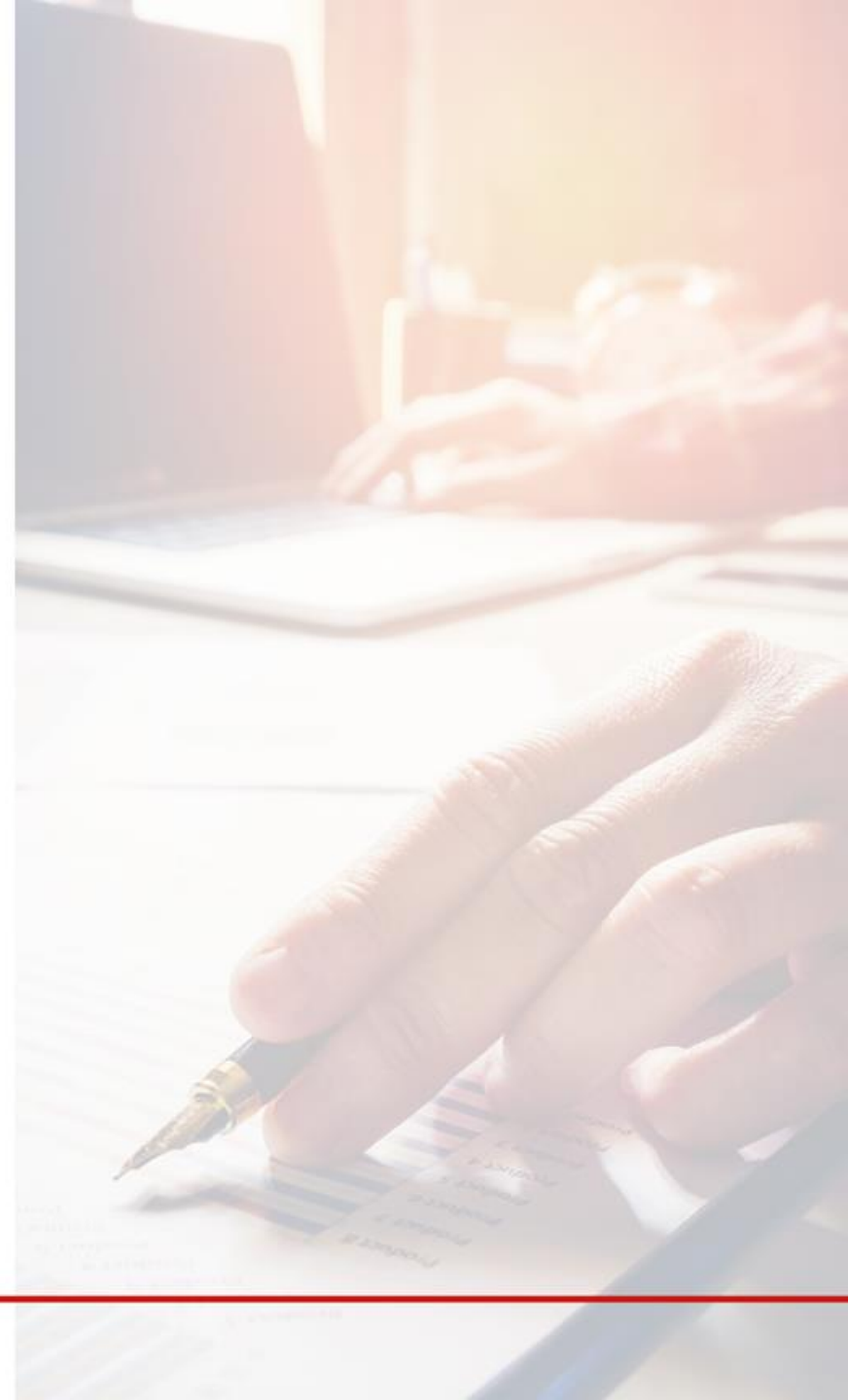

# Why Automate?

- **Control Incoming & Outgoing Products**
  - Validate correct items are received, shipped, counted
  - Identify potential overages/shortages
- **Simplify & Streamline Process**
  - Mobile devices on the floor as primary data access & input
  - Eliminate duplicate data entry efforts
  - Real time data for purchasing and customer orders
- **Reduce Cost**
  - Eliminate data entry errors & redundancies
  - Accurate data collection for immediate decisions



# What is Mobility?



# A Day in the Life of Inventory



## PURCHASE ORDER

Page: 1



P.O. NUMBER : 0095076  
ORDER DATE : 05/25/03

VENDOR NUMBER : COMSUP

VENDOR :  
COMPUTER SUPPLY COMPANY  
19890 ADAMS BOULEVARD  
COSTA MESA, CA 92626

SHIP TO :  
XYZ MANUFACTURING COMPANY  
14851 JEFFREY RD.  
IRVINE, CA 92714

CONFIRM TO :

REQUIRED DATE	SHIP VIA	F.O.B.	TERMS				
05/25/03	UPS		NO TERMS				
ITEM NUMBER	UNIT	ORDERED	RECEIVED	BCK ORDER	UNIT COST	AMOUNT	
BOARD-04230 MOTHERBOARD	EACH	25	0	WHSE: 000	295.550	7,388.75	
CAPAC-14549 CAPACITORS	EACH	25	0	WHSE: 000	0.700	17.50	
COVER-01000-IH CABINET MODEL 1000	EACH	25	0	WHSE: 000	15.330	383.25	
EXMEM-00080-SM MEMORY EXTENSION CARD - SIMMS	EACH	25	0	WHSE: 000	99.000	2,475.00	
SWITCH-110AC POWER SWITCH (110V AC)	EACH	10	0	WHSE: 000	5.150	51.50	

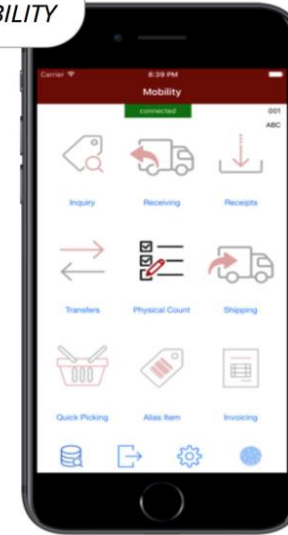

WI-SAGE100-2018

# ROG Against Purchase Order

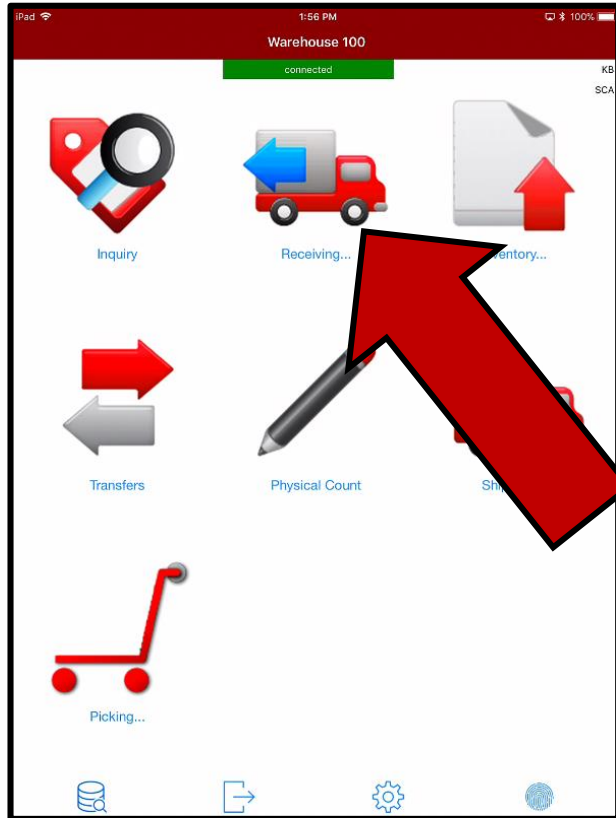

Purchase Order

Batch # 01555  
Order # 0001281  
Item RPM8040DR  
RPM 80W90 DRUM  
Warehouse L01 PORTLAND  
UOM LBS  
Bin  
Qty Rcv/Tot 5/5  
Quantity

- Choose PO Number
- Choose Item
- Enter Quantity Received

Purchase Order

Batch # 01555  
Order # 0001281  
Item

Send to Sage Icon will generate ROG Transaction

# Physical Counts

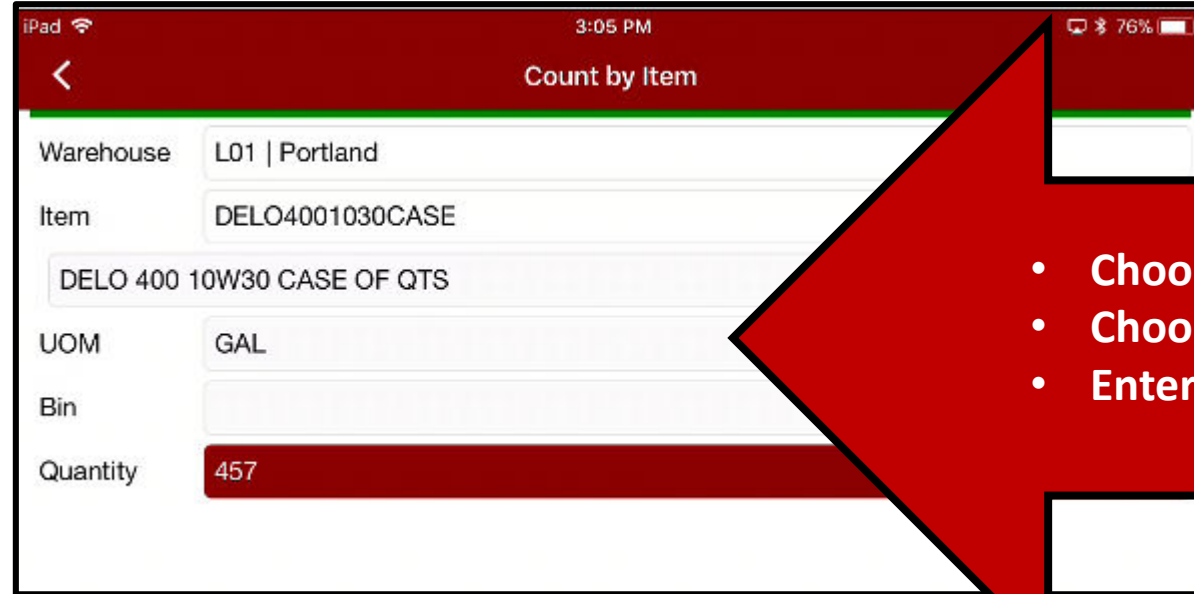
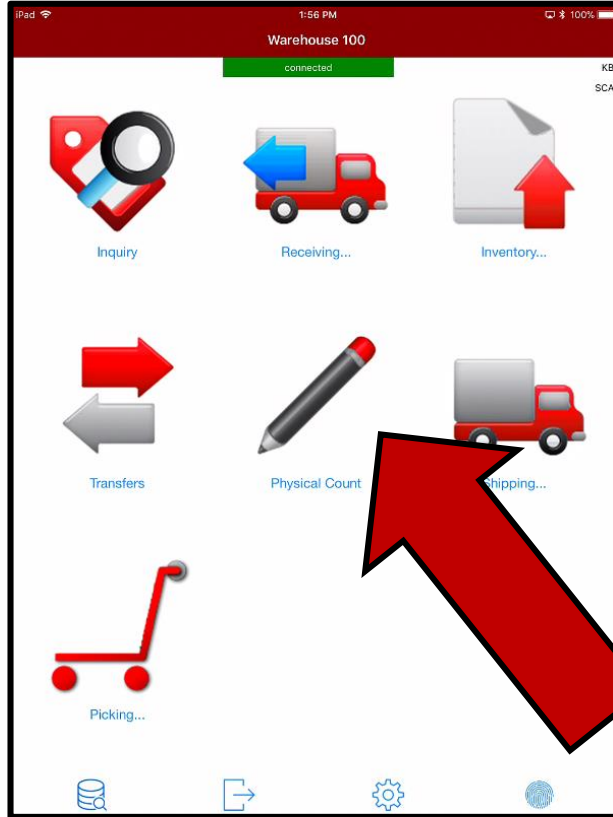

- Choose Warehouse
- Choose Item
- Enter Quantity Counted

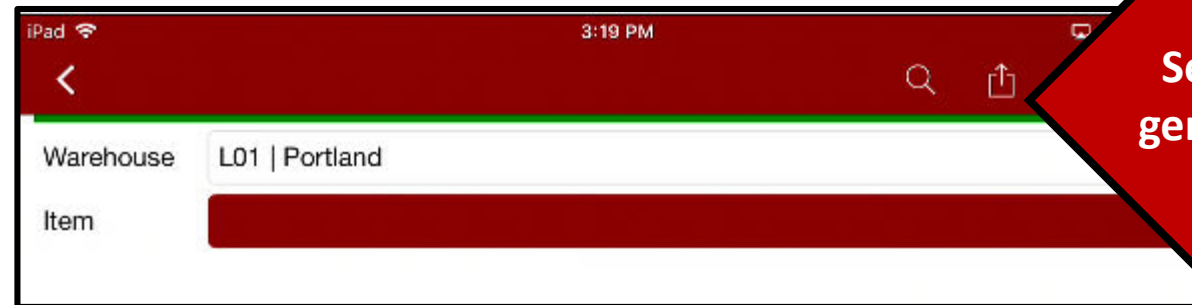

Send to Sage Icon will generate PC Transaction



# Sales Order Invoice Data Entry

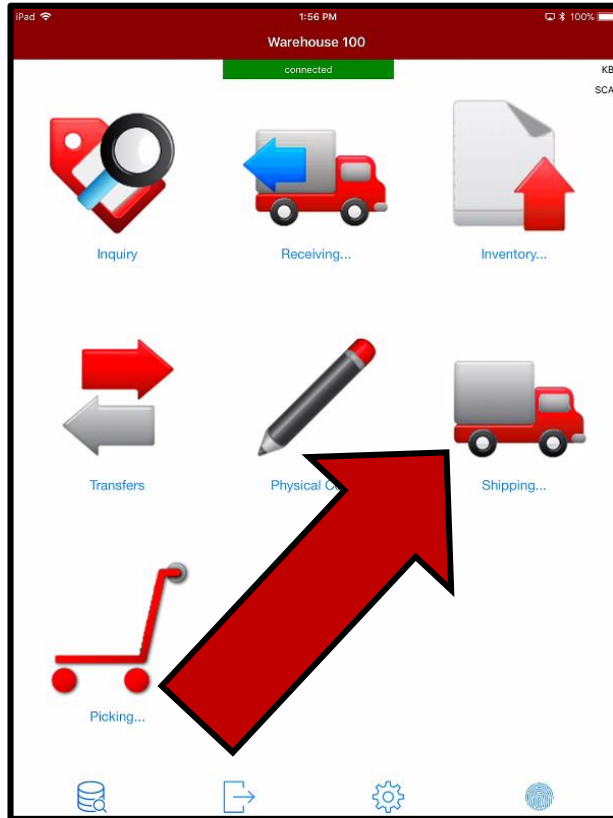

iPad 4:23 PM 48%

Invoicing

Batch # 08889

SO # L25535

Item SUPREME10W30CSQ  
SUPREME 10W-30 CASE OF QTS

Warehouse A01 | PORTLAND

UOM GAL

Bin

Qty Avail 0

Qty Shp/Ord 0/3

Quantity

- Choose Sales Order
- Choose Item
- Enter Quantity Shipping

iPad 4:25 PM

Batch # 08889

SO # L25535

Item

Send to Sage Icon will generate SO IDE



# Questions & Answers



THANK YOU  
FOR LISTENING!

**For Additional Information  
Please Contact Kristen Baumgartner  
(815) 679-9003  
[kristen@scanco.com](mailto:kristen@scanco.com)**